

## Amy McClure

---

**From:** Anna Slocum  
**Sent:** Wednesday, March 14, 2018 2:12 PM  
**To:** Amy McClure  
**Subject:** RE: Pool Options

Thanks Amy. I understand your concerns. Even on a computer the renderings are difficult to read. I am struggling with these designs also but have been tasked to look at this from a different perspective so I am going to do the same to you.

Consider this point of view... from an operational and cost benefit standpoint – why would we spend the bulk of the money on a facility that is going to operate about 90 days / year? Also, this is no longer a seasonal facility so the goal is to entice people to purchase an annual membership, what amenities do we need to sell this year-round to families? If looking for a return on investment the more we pack indoors the better our rate of membership will be. Remember, when a pass is purchased whether annually or seasonally, they will have access to both the indoor and outdoor area as well as the other amenities of the building. That being said, I agree the outdoor pool is lacking a wow factor of just a 25 meter pool. Although I would anticipate the new aquatic coordinator to try and build the swim team back - I am not sure what luck we will have after a year of not having one. But if it is revived, the starting blocks will be on the diving board end and the boards will be “lifted” to allow for the lanes to be used as the start which is typical when dive and swim meets are not happening at the same time. Since we meet with the designer tomorrow I am wondering if there are site restrictions and that is why we are limited to 6 lanes – although not ideal, 6 lanes will function for a meet – Gladstone runs meets with 4 lanes!

I understand your concern about the spray park, but the idea is that will allow for “shoulder” season outdoor when the weather allows and does not require staffing – which since it is part of the facility will also help when the indoor pool is scheduled for lessons or classes.

There is a design committee and design charrettes so I am curious as to what information we will draw from those but I also believe there will be a way to educate residents to how and why designs were chosen – but at the end of the day they might also prove to the powers that be that although logically their arguments make sense it is not what people want.

I have staffing questions for several of the options as well.

Once I meet with the designers I will let you know what additional information they share or changes we make.

Enjoy California!

Anna

**From:** Amy McClure  
**Sent:** Wednesday, March 14, 2018 12:21 PM  
**To:** Anna Slocum <aslocum@merriam.org>  
**Subject:** Re: Pool Options

Anna,

I want to be completely honest with you. I don't think the community is going to be pleased with this design.

The outdoor design lacks any attractions that may bring families to our facility.

A 6 lane pool is not conducive to hosting swim meets. A competition pool has 8 lanes. With diving boards in the 12 foot, you will need a recommended 4 feet depth for starting blocks on the opposite end. This design has 3'6" depth.

A spray park doesn't really add to the idea of an aquatic facility. It sounds more like an attraction for a park.

If I had to choose between these two designs, I would pick #2. Only because it's slightly bigger with the added area around the steps.

As for the indoor facility, I think all three options look good. This is more of a design I was expecting for the outdoor facility.

I like the set up of #1 mainly because it seems to flow better.

In #2, I like the idea of having the therapy pool away from the kids area due to loud noise and splashing. But I do not like the lap pool being at an angle. And I'm not sure what a vortex is, I assume it's a slide but I don't understand the function.

I like #3 also because of the flow of the layout.

Going into this, I knew the outdoor facility may become smaller due to total cost of the project. However, I had no idea it would be reduced to this. I think the general public is going to be disappointed to say the least.

I would have expected the indoor facility to have a 4 lane 25 meter pool, therapy pool, and a small zero depth play area.

I would have expected the outdoor facility to be 8 lane 25 meter competition pool, diving boards, lazy river, and zero depth kids play area.

I'm in California on spring break so I had to look at these on my phone. This is just a quick idea of what I'm seeing in the design.

Let me know if you have any other questions.

Thanks!  
Amy

On Mar 14, 2018, at 8:16 AM, Anna Slocum <[aslocum@merriam.org](mailto:aslocum@merriam.org)> wrote:

Amy-

The designs I am sharing are for your eyes only. This is the first pass of possible pool designs – indoor and outdoor.

I would like your opinion – please keep in mind that it is my goal that the outdoor will also include a spray ground which is not featured in the plans.

We are meeting with the design group tomorrow morning so any input prior is greatly appreciated.

**Anna Slocum**  
Merriam Parks and Recreation  
5701 Merriam Drive

THEATRY POOL DATA  
 SURFACE AREA = 640 SQ FT  
 PERIMETER = 104 FT  
 DEPTHS = 3'-0" TO 4'-3"  
 VOLUME = 16,200 GAL.  
 3 HE. THROUGH = 125 GPM

ACTIVITY POOL DATA  
 SURFACE AREA = 6100 SQ FT  
 PERIMETER = 384 FT  
 DEPTHS = 0'-0" TO 4'-0"  
 VOLUME = 141,200 GAL.  
 3 HE. THROUGH = 785 GPM

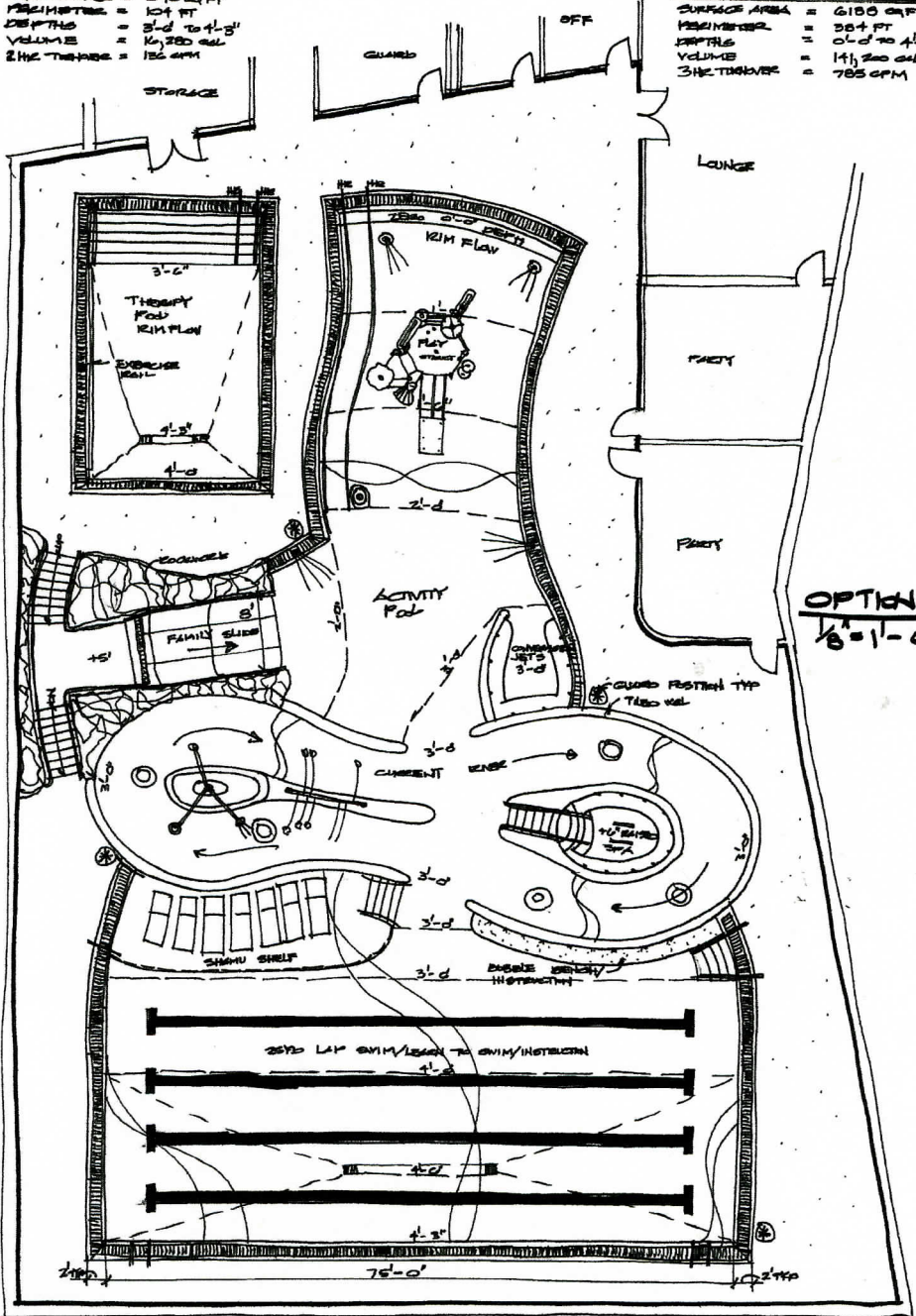

OPTION 1  
 $\frac{1}{8} = 1'-0"$

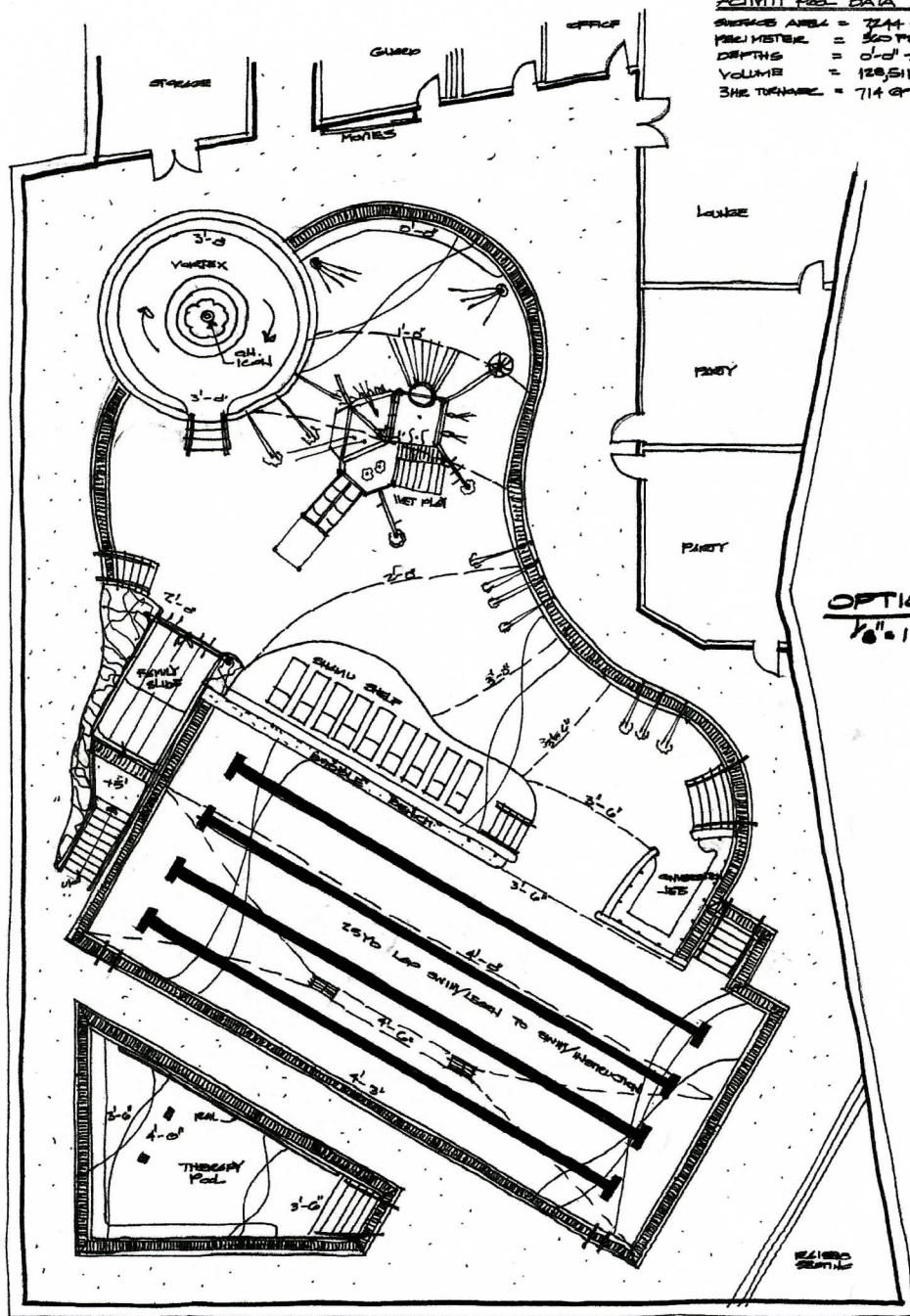

ACTIVITY Pool DATA  
 SURFACE AREA = 7244 SQ FT  
 PERIMETER = 360 FT  
 DEPTHS = 0'-0" TO 4'-0"  
 VOLUME = 128,511 GAL  
 2HE TURBINE = 714 GPM

OPTION 2  
 1/8" = 1'-0"

THERAPY Pool DATA  
 SURFACE AREA = 809 SQ FT  
 PERIMETER = 104 FT  
 DEPTHS = 3'-0" TO 4'-0"  
 VOLUME = 14,100 GAL  
 2HE TURBINE = 118 GPM

THErapy Pool DATA  
 SURFACE AREA = 536 SQ FT  
 PERIMETER = 79 FT.  
 DEPTHS = 3'-6" TO 4'-3"  
 VOLUME = 15,672 GAL  
 SHE TURBINE = 151 GPM.

ACTIVITY POOL DATA  
 SURFACE AREA = 614 SQ FT  
 PERIMETER = 424 FT  
 DEPTHS = 0'-6" TO 4'-6"  
 VOLUME = 148,000 GAL  
 SHE TURBINE = 825 GPM

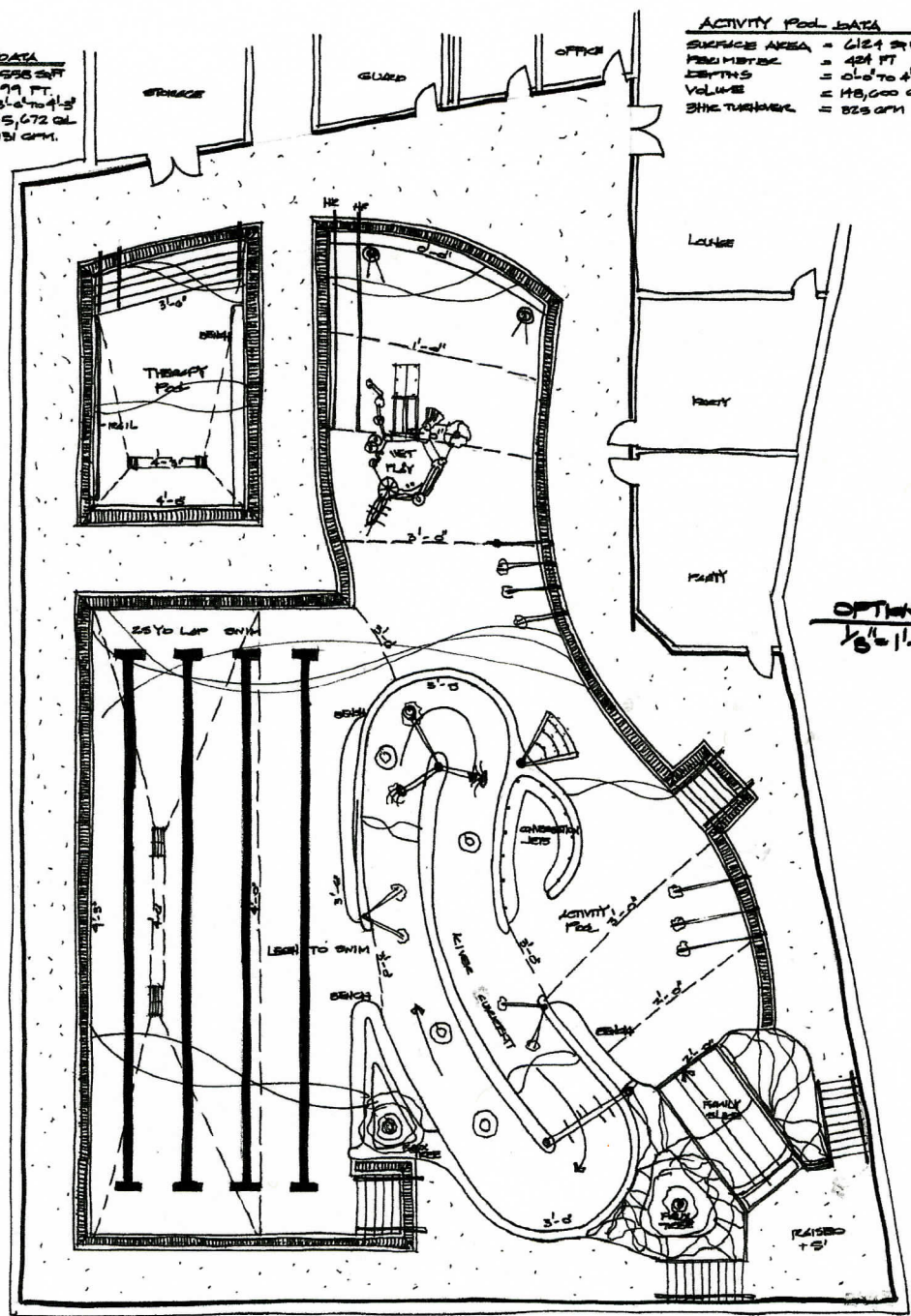

OPTION 3  
 1/8" = 1'-0"

OUTSIDE FEEL DATA  
 SURFACE AREA = 3005 SFT  
 PERIMETER = 202 FT  
 VOLUME = 247,000 CU  
 CONE TREATMENT = 2000 GPM

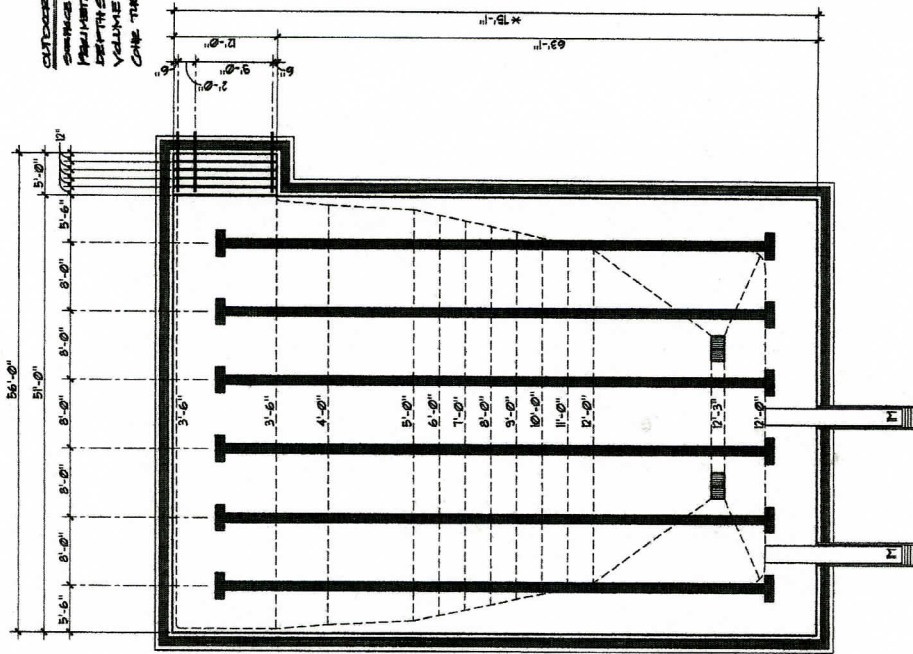

OUTDOOR POOL DATA  
 SURFACE AREA = 4009 SQ FT  
 PERIMETER = 282 FT  
 DEPTHS = 3'-0" TO 12'-3"  
 VOLUME = 233,122 GAL  
 CIRC TO = 648 CFM

